



23305  
**TRIBECA**  
**CHAIR**

Experience a truly personalized seating option with the Tribeca mid-century modern chair, designed to cater to your individual tastes and preferences. We provide a range of three arm styles and three seat depths for you to choose from. Every element of our custom furniture is meticulously selected for durability, from the resilient Qualux Foam to the sturdy frame, guaranteeing long-lasting quality.

**FEATURES + CUSTOMIZATIONS**

- Standard with feather and fibre blend, box back cushions.
- Standard with fibre wrapped Qualux foam, box seat cushions with top stitching (minimum 2.5 lb density).
- Your choice of slope arm (A01), wedge arm (A02), or track arm (A03).
- Optional 21", 22" or 23" seat depth – please specify on your order.
- Customize your comfort level – Firm, Soft, or Ultra-Lux.
- The frame is crafted from a combination of engineered and solid wood.
- Crafted in Canada.

FROM THE  
**TRIBECA COLLECTION**



23005



23805



23305



23105



23205



23005-30



SEAT DEPTH: 21", 22" OR 23"

SEAT HEIGHT: 18"

ARM HEIGHT: 25"



A01 ARM STYLE

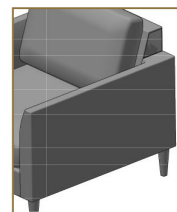

A02 ARM STYLE



A03 ARM STYLE